

2/3 BUTTON ICON TAPS

DATA SHEET



LEGEND:

- A - 1/2" F hot water wall connection
- B - 1/2" F cold water wall connection
- C - 1/2" F wall connection (for 2nd outlet connection)
- D - 1/2" F wall connection (for 3rd output connection, only for 3-button Icon version)
- R - Tap fixing area
- S - Centering plate fixing holes
- ** - Recommended height from shower tray

ATTACHMENT CENTERING PLATE

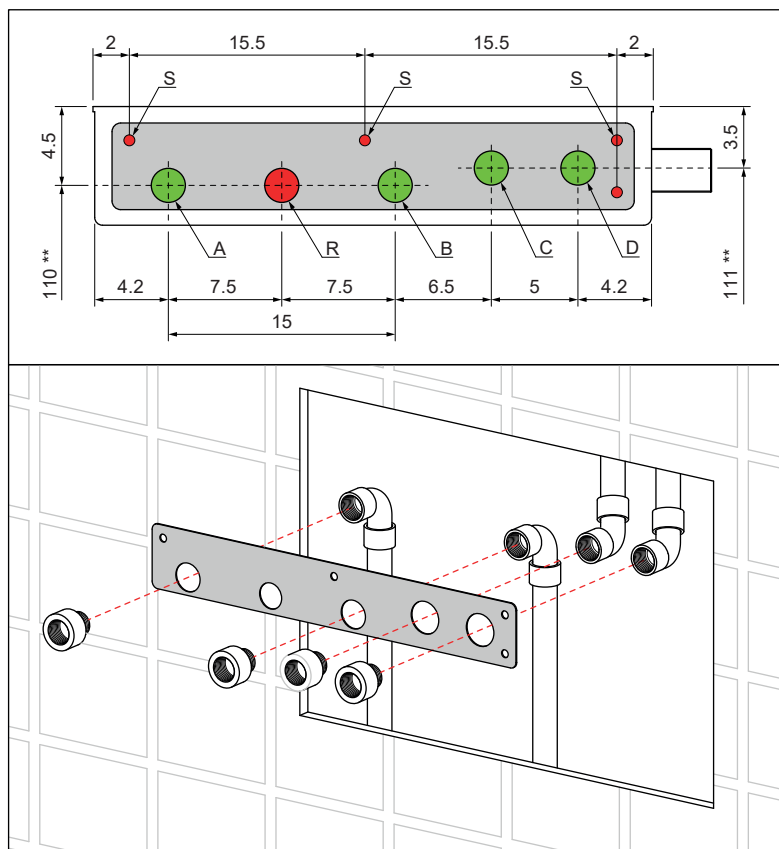

2-BUTTON ICON TAPS

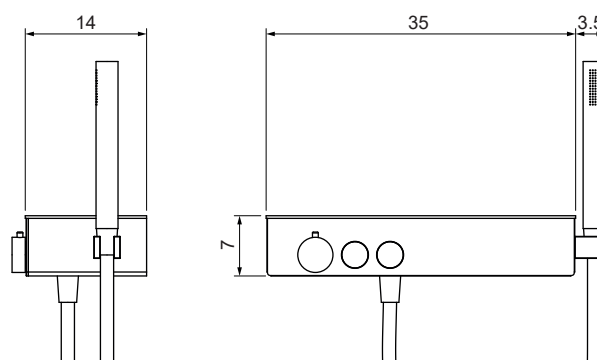

3-BUTTON ICON TAPS

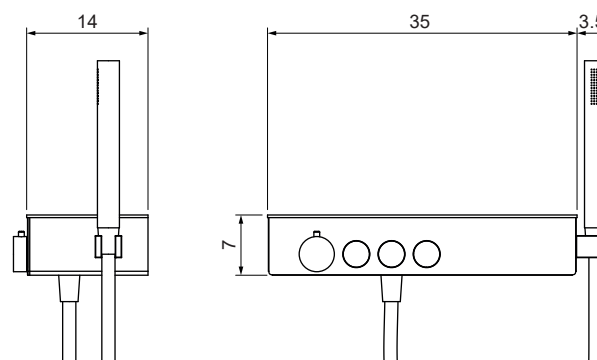

TECHNICAL DATA:

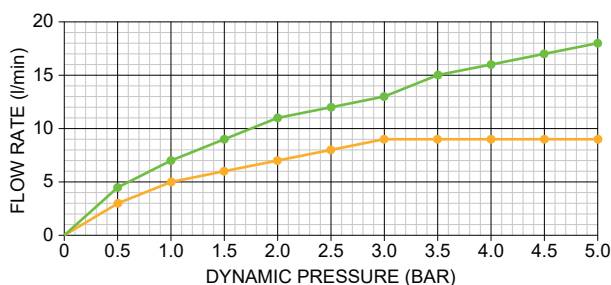

	BAR	0.5	1.0	1.5	2.0	2.5	3.0	3.5	4.0	4.5	5.0
SHOWER	l/min	3.2	4.8	6.0	7.0	7.8	8.6	9.0	9.0	9.0	9.0
2/3° EXIT	l/min	4.6	7.3	9.2	10.8	12.2	13.4	14.6	15.7	16.7	17.6

PACKAGING

DIMENSIONS			WEIGHT	
LENG.	WIDTH	HEIG.	NET	GROSS
X	X	X	X	X



Operating pressure:
- MIN 150 kPa (1.5 bar)
- MAX 300 kPa (3.0 bar)



Hot water temperature:
- MAX 60°C (140°F)

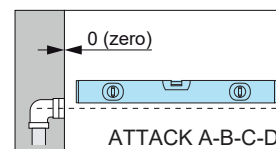
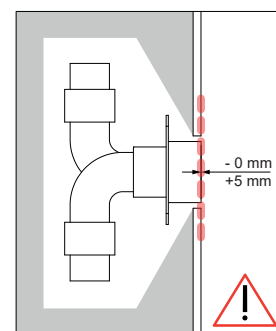

If the water pressure is higher than indicated, install pressure reducers. Provide stopcocks outside the product footprint to shut off the hot and cold water.

- Installation must be done on finished walls. Make sure that the pipes do not pass through where the fixing holes are to be made.
- The dimensions are expressed in cm. The actual dimensions may vary by ± 0.3 cm.

WARNING: In the event of non-compliance, even partial, with the safety conditions, both the warranty and the manufacturer's liability for any direct or indirect damage caused by the product will expire. The expiration of the warranty, in the above-mentioned case, will result in the replacement of only those parts that are recognized as defective, without covering the costs deriving from the labor necessary to remove the product.